



# Astore Keymak

a member of the HUDACO Group

“Driven by quality; Delivered by experience!”

## SAFE BLOCK BALL VALVES

### VERSUS

## NON SAFE BLOCK BALL VALVES

### COMPARING THE 2 TYPES OF VALVES

[www.astorekeymak.co.za](http://www.astorekeymak.co.za)

[info@astorekeymak.co.za](mailto:info@astorekeymak.co.za)

#### Safe Block Ball Valves - Blue Handle



- Either in Single Union or Double Union
- Plain For solvent Welding or BSP Female Threaded.
- With micro adjustment of "Ball Seat".

#### General Characteristics

Single and Double Union Ball Valve - Compact Type - characterised by optimal handling, full flow, axial pipe load block with micro adjustment of ball seat. Moreover in the closed position the pipeline can be disconnected downstream from the valve

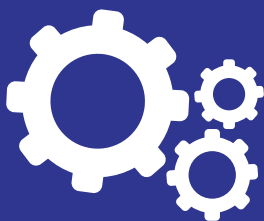

Our valve can be used mainly for water treatment, swimming pools, water systems, irrigation systems and drinking water pipeline systems, low aggressive chemical liquids, etc

When looking at the below exploded view, the Safe Block Valve comes with Adjustable Support and this adjustable support comes standard with threads. (Not all Blue Handled Ball Valves in the South African market are necessary Safe Block)

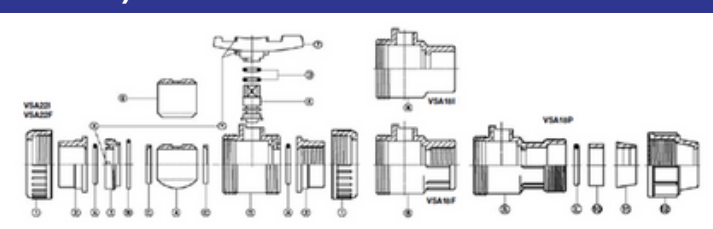

Pos	Components	Material
1	Union Nut	PVC
2	End Connector	PVC
3	Adjustable Support	PVC

#### Non Safe Block Ball Valves - Grey Handle



- Either in Single Union or Double Union
- Plain For solvent Welding or BSP Female Threaded.

In general, the major difference between a Non Safe Block Ball Valve is that the Non Safe Block Ball Valve has a "support" (Push in support without Threads- Non Adjustable) and not suitable to safely block full system pressure in either direction and a Safe Block Ball Valve comes standard with Adjustable Support and threads as standard to safely block full system pressure in either direction.



With a Non Safe Block Ball Valve, it is not possible to safely block full system pressure in either direction to allow on-line system maintenance

When looking at the below exploded view, the Non Safe Block Valve comes with Support, this support has no threads. "Push In Support", this "Support" is not adjustable like in the case with a Safe Block Ball Valve.

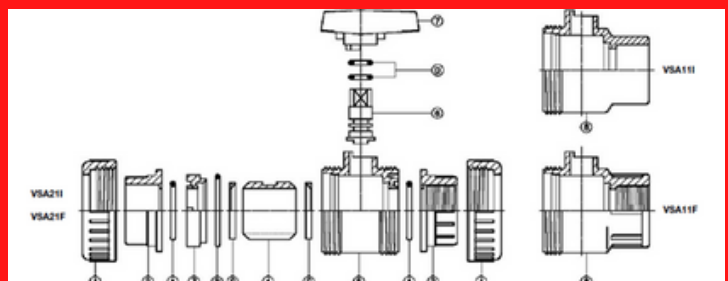

Pos	Components	Material
1	Union Nut	PVC
2	End Connector	PVC
3	Support	PVC