

**UNDERCLAMP  
TAPPING SADDLE**

Technical Sheet

[info@astorekeymak.co.za](mailto:info@astorekeymak.co.za)  
[www.astorekeymak.co.za](http://www.astorekeymak.co.za)



CODE	DIM [mm]	BOLTS NUMBER	Bolt Type	PN [bar]
SADU10250110020	110x20	6	M8x60	16
SADU10250110025	110x25	6	M8x60	16
SADU10250110032	110x32	6	M8x60	16
SADU10250160020	160x20	6	M8x100	16
SADU10250160025	160x25	6	M8x100	16
SADU10250160032	160x32	6	M8x100	16

**TECHNICAL FEATURES:**

- Suitable for PE and PVC
- Material: PP-B
- Cutter: Brass
- Seal: NBR O-ring
- Bolts: stainless steel A4

**STANDARDS:**

- For PE pipes:  
UNI EN 12201 - ISO 4427 - DIN 8074
- For PVC pipes:  
UNI EN 1452 - DIN 8062
- Tested according to:  
ISO 13460

**HEALTH STANDARDS:** Unidelta underclamp tapping saddles comply with the regulations on the conveyance of drinking water, in accordance with the regulations applicable in Italy and numerous other countries. Ministerial Decree no. 174 of 06/04/2004.

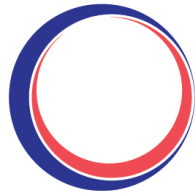

**UNDERCLAMP  
TAPPING SADDLE**

Technical Sheet

**info@astorekeymak.co.za**  
**www.astorekeymak.co.za**

UNDERCLAMP TAPPING SADDLE - COMPONENTS

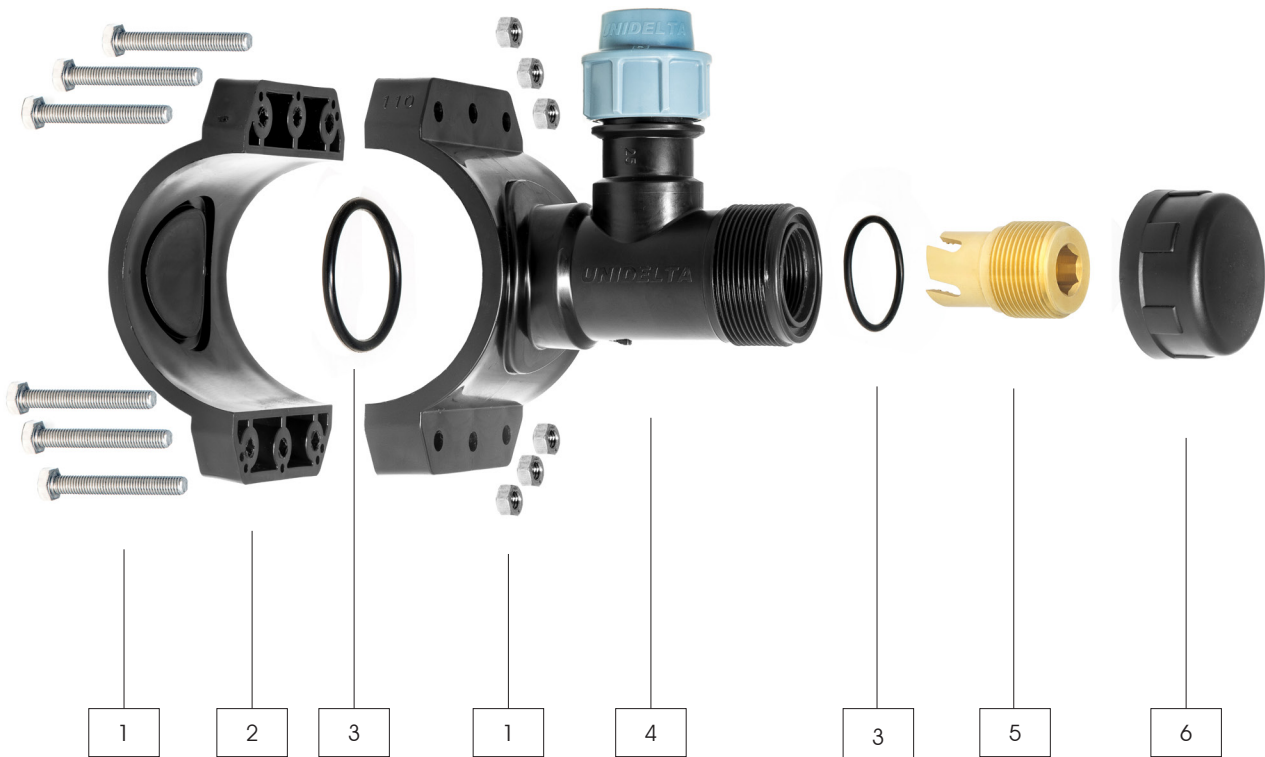

1. Bolts: Stainless steel A4
2. Bracket bottom: Polypropylene (PP-B) with high degree of stability and protection against UV.
3. Gaskets: nitrile rubber (NBR)
4. Load bracket take off: Polypropylene (PP-B) with high degree of stability and protection against UV.
5. Perforator: Brass
6. Plug: Polypropylene (PP-B) with high degree of stability and protection against UV.